

Floorplans & Specs



Index

	<u>Page</u>
West Building 100 Level	2 - 3
West Building 200 Level	5 - 6
West Building 300 Level	7 - 8
North Building 100 Level	9 - 10
North Building 200 Level	11 - 12
North Building 300 Level	13 - 14
North & West Building Lower Level	15 - 16

PHOENIX CONVENTION CENTER

WEST BUILDING

NORTH BUILDING



300 LEVEL

WEST BUILDING

NORTH BUILDING

45,200 SF West Ballroom
Riser seating for 1,200

190,000 SF Exhibition Hall

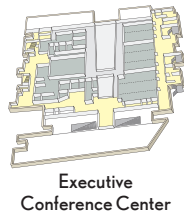

Executive
Conference Center

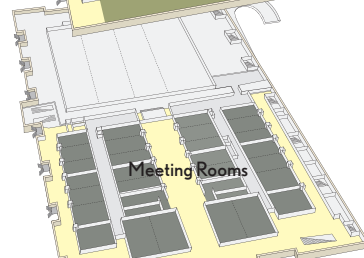

Meeting Rooms

200 LEVEL

WEST BUILDING

NORTH BUILDING

21,000 SF Conference Center
IACC Certified
192-Seat Lecture Hall

43,000 SF Meeting Rooms

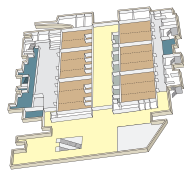

Meeting Rooms

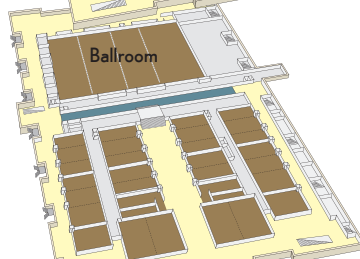

Ballroom

100 LEVEL

WEST BUILDING

NORTH BUILDING

27,200 SF Meeting Rooms

45,600 SF Ballroom
43,000 SF Meeting Rooms

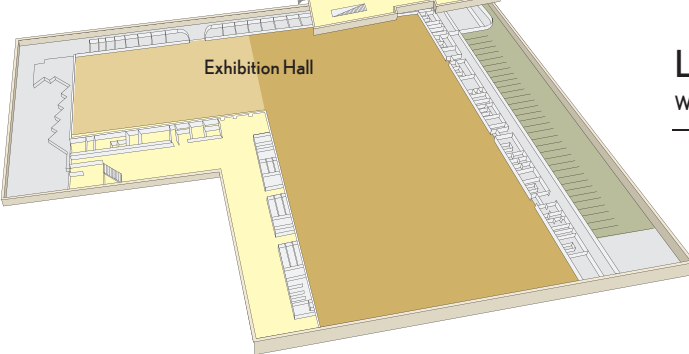

Exhibition Hall

LOWER LEVEL

WEST BUILDING

NORTH BUILDING

312,500 Total Combined SF Exhibition Hall

100 LEVEL SOUTH BUILDING

28,000 SF Ballroom
82,000 SF Exhibition Hall
33,000 SF Meeting Space

Expands to 143,000 SF Expo Hall

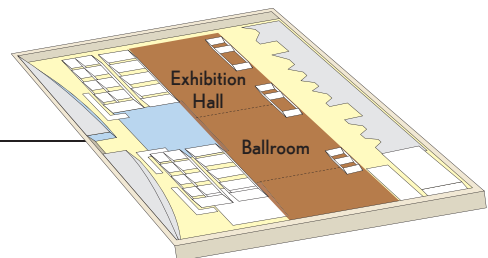

PHOENIX CONVENTION CENTER

West Building | Meeting Rooms | 100 Level | Street Level

MONROE STREET



See reverse side for capacity information.

PHOENIX CONVENTION CENTER

West Building | Meeting Rooms | 100 Level | Street Level

MEETING SPACE

ROOM	AREA (SF)	DIMENSIONS	CEILING HGT	THEATER	CLASSROOM	BANQUET	RECEPTION
101 - A	1,722	67'x28'	16'	164	93	60	155
101 - B	1,846	66'x30'	16'	163	93	60	169
101 - C	1,822	65'x28'	16'	168	93	70	164
101 - ABC	5,390	67'x86'	16'	495	279	190	482
102 - A	1,707	64'x28'	15'	162	93	60	148
102 - B	1,786	63'x30'	15'	163	93	60	153
102 - C	1,743	62'x28'	15'	168	93	70	157
102 - ABC	5,236	64'x86'	15'	493	279	190	471
103 - A	1,418	45'x28'	16'	123	71	50	128
103 - B	1,281	51'x25'	16'	114	57	50	115
103 - AB	2,699	52'x53'	16'	237	128	100	243
104 - A	1,487	60'x25'	16'	137	75	70	134
104 - B	1,678	61'x28'	16'	164	93	60	151
104 - AB	3,165	64'x53'	16'	301	168	130	285
105 - A	1,752	62'x28'	16'	168	93	70	156
105 - B	1,785	63'x30'	16'	163	93	60	160
105 - C	1,740	64'x28'	16'	164	93	60	157
105 - ABC	5,277	68'x86'	16'	495	279	190	475
106 - A	1,834	65'x28'	16'	168	93	70	161
106 - B	1,846	65'x30'	16'	164	93	60	166
106 - C	1,716	67'x28'	16'	164	93	60	155
106 - ABC	5,396	70'x86'	16'	496	279	190	540
TOTAL	27,200						

ATRIUM LOBBY
ARCADE

13,000 SF
11,700 SF

Standard Set Classroom 3 chairs per 6' Table
4 chairs per 8' Table

ALL NUMBERS REFLECT
ATTENDEE CAPACITY

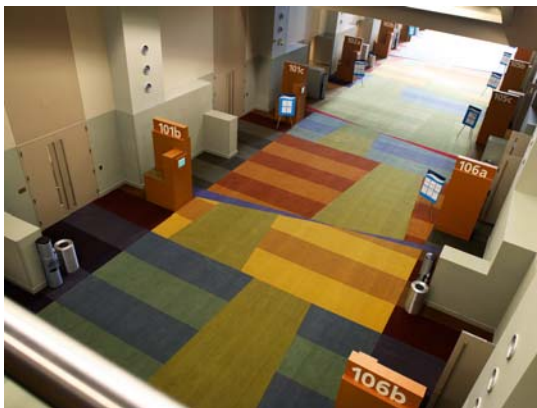

West Building Arcade



Meeting Room



For more information, or to reserve event space
please call: 800.282.4842 or visit: phoenixconventioncenter.com

100 North Third Street | Phoenix, AZ 85004
602.262.6225 | TTY 602.495.5048



FAMILY OF VENUES

Phoenix Convention Center | Executive Conference Center | Symphony Hall | Orpheum Theatre

4/2012



PHOENIX CONVENTION CENTER

West Building | 200 Level

200 Level

	AREA(SF)	DIMENSIONS	CEILING HGT.	STANDARD	CLASSROOM	CONFERENCE	U-SHAPE	HOLLOW	PODS
LECTURE HALL (207)	4,735	72' x 66'		TIERED CLASS	192				
BOARD ROOMS									
201	540	28' x 24'	10'	CONF	-	14	-	-	-
201 - Reception	552	18' x 30'	10'	-	-	-	-	-	-
202	811	29' x 30'	10'	U-SHAPE	-	-	16	-	-
203	434	19' x 24'	10'	U-SHAPE	-	-	10	-	-
204	277	15' x 19'	10'	CONF	-	6	-	-	-
205	427	28' x 24'	10'	U-SHAPE	-	-	12	-	-
206	427	23' x 19'	10'	U-SHAPE	-	-	12	-	-
208	1,435	35' x 44'	13'	U-SHAPE	52	-	28	40	48
208 - A	762	32' x 23'	13'	U-SHAPE	28	20	20	24	24
208 - B	673	32' x 21'	13'	U-SHAPE	24	20	20	24	24
TOTAL	4,903								
CONFERENCE ROOMS									
	AREA(SF)	DIMENSIONS	CEILING HGT.	STANDARD	CLASSROOM	ROUNDS	U-SHAPE	HOLLOW	PODS
211	3,853	63' x 68'	11'	PODS	154	160	48	68	108
211 - A	1,817	55' x 32'	11'	PODS	76	70	36	40	54
211 - B	2,036	55' x 36'	11'	PODS	78	90	36	44	54
212	4,432	57' x 86'	11'	CLASS	156	150	50	80	108
212 - A	1,420	49' x 28'	11'	CLASS	52	50	30	36	36
212 - B	1,580	49' x 30'	11'	CLASS	52	50	30	36	36
212 - C	1,432	49' x 28'	11'	CLASS	52	50	30	36	36
213	2,867	61' x 54'	11'	RDS	98	100	40	60	72
213 - A	1,429	49' x 28'	11'	RDS	52	50	30	36	36
213 - B	1,438	49' x 26'	11'	RDS	44	50	30	36	36
TOTAL	11,152								
<div> <div>TOTAL PRE-FUNCTION – EAST</div> <div>7,750 SF</div> <div>PRE-FUNCTION – WEST</div> <div>6,000 SF</div> <div>ALL NUMBERS REFLECT ATTENDEE CAPACITY</div> </div>									

Designed for high-end, professional meetings and events, the Executive Conference Center Level offers nearly 21,000 square feet of meeting space and meets International Association of Conference Centers (IACC) standards.



Lecture Hall



Executive Board Room



ECC Pre-function space



For more information, or to reserve event space
please call: 800.282.4842 or visit: phoenixconventioncenter.com
100 North Third Street | Phoenix, AZ 85004
602.262.6225 | TTY 602.495.5048



FAMILY OF VENUES

Phoenix Convention Center | Executive Conference Center | Symphony Hall | Orpheum Theatre

4/2012

PHOENIX CONVENTION CENTER

West Building | West Ballroom | 300 Level

MONROE STREET

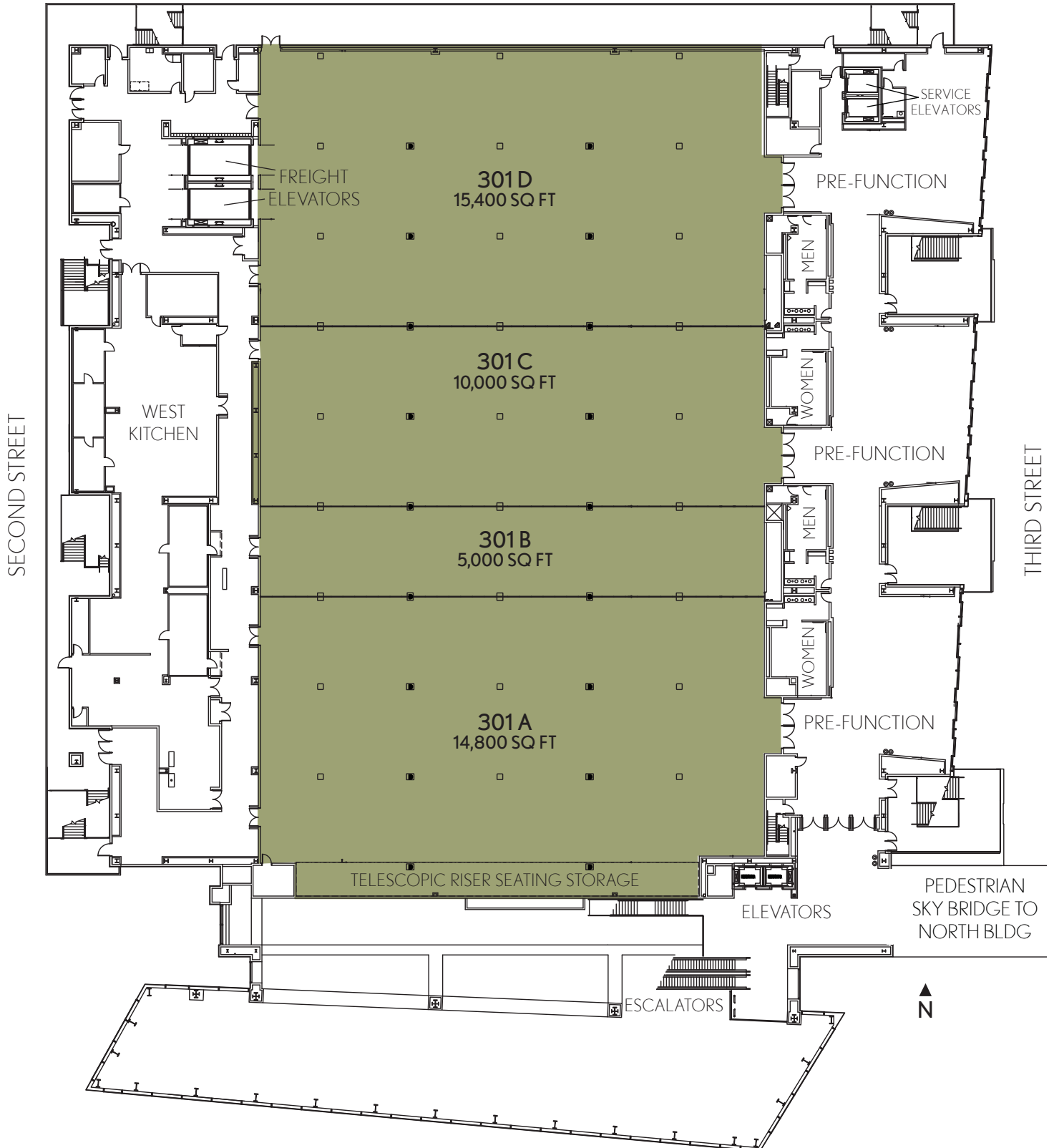

See reverse side for capacity information.

PHOENIX CONVENTION CENTER

West Building | West Ballroom | 300 Level

BALLROOM SPACE

ROOMS - UPPER LEVEL	AREA (SF*)	DIMENSIONS	CEILING HGT.	THEATER	CLASSROOM	BANQUET	EXHIBIT	RECEPTION
301 - A-D	45,200	169' x 268'	30'	4,560	2,807	2,470	254	4,068
301 - A	14,800	169' x 86'	30'	1,464	876	700	84	1,332
301 - A	(14,800)	(169' x 86')	(30')	(1,200 telescopic riser seating)				
**301 - A-B	19,800	169' x 117'	30'	1,848	1,200	920	112	1,782
**301 - B-C	15,000	169' x 90'	30'	1,504	884	700	86	1,350
301 - C	10,000	169' x 60'	30'	942	577	450	58	900
301 - C-D	25,400	169' x 151'	30'	2,644	1,582	1,180	144	2,286
301 - D	15,400	169' x 92'	30'	1,504	884	700	88	1,386
TOTAL	45,200							
PRE-FUNCTION	9,100 SF			Standard Set Classroom	3 chairs per 6' Table		ALL NUMBERS REFLECT ATTENDEE CAPACITY	
*SF Area rounded.	** 301B cannot be used alone				4 chairs per 8' Table			

The West Ballroom offers 45,000 square feet of multi-purpose carpeted space with the ability to host banquets, general sessions and tradeshows. This level has a floor weight capacity of 250 pounds/square foot. Two freight elevators (cap: 9'h x 9'w x 19'l, door: 8'h x 9'w), one with a weight capacity of 20,000 pounds and the second with a 10,000 pound capacity, provide easy accessibility to the West Ballroom from the loading dock area.

To enhance the line of sight for stage productions, retractable telescopic riser seating for 1,200 with padded seats and arm rests is available. Numerous rigging points with weight capacities ranging from 300 to 2,000 pounds per point each allow the room to accommodate banners and elaborate lighting displays.



West Ballroom Gala



West Ballroom Pre-function



For more information, or to reserve event space
please call: 800.282.4842 or visit: phoenixconventioncenter.com

100 North Third Street | Phoenix, AZ 85004
602.262.6225 | TTY 602.495.5048



FAMILY OF VENUES

Phoenix Convention Center | Executive Conference Center | Symphony Hall | Orpheum Theatre

PHOENIX CONVENTION CENTER

North Building | North Ballroom & Meeting Rooms

100 Level | Street Level



Outdoor Patio



metroMarché



North Ballroom Pre-function



3rd Street facing south towards Phoenix Convention Center



North Meeting Room



North Building & Light Rail

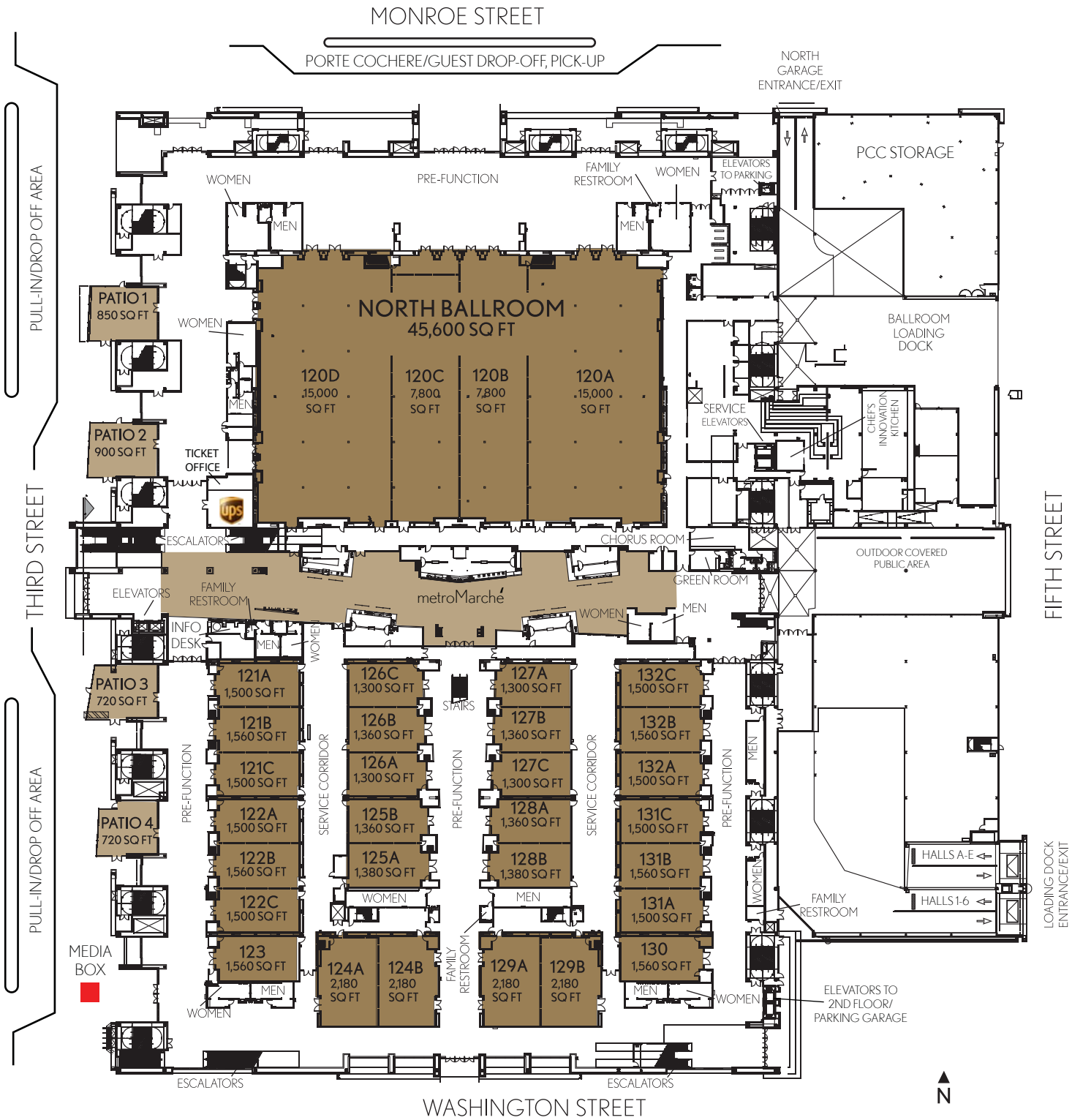

North Building | Ballroom & Meeting Rooms
100 Level | Street Level

MEETING SPACE

ROOM - STREET LEVEL	AREA (SF*)	DIMENSIONS	CEILING HGT.	THEATER	CLASSROOM	BANQUET	RECEPTION
121A	1,500	54' x 29'	16'5"	144	82	50	100
121B	1,560	54' x 30'	16'5"	156	82	50	105
121C	1,500	54' x 29'	16'5"	144	82	50	100
121A-C	4,560	54' x 88'	16'5"	444	246	150	305
122A	1,500	54' x 29'	16'5"	144	82	50	100
122B	1,560	54' x 30'	16'5"	156	82	50	105
122C	1,500	54' x 29'	16'5"	144	82	50	100
122A-C	4,560	54' x 88'	16'5"	444	246	150	305
123	1,560	54' x 30'	16'5"	156	82	50	105
124A	2,180	38' x 60'	16'5"	220	121	110	145
124B	2,180	38' x 60'	16'5"	220	121	110	145
124AB	4,360	76' x 60'	16'5"	440	242	220	290
125A	1,380	52' x 29'	16'5"	128	60	50	90
125B	1,360	51' x 29'	16'5"	118	60	50	90
125AB	2,760	52' x 58'	16'5"	246	120	100	180
126A	1,300	49' x 29'	16'5"	118	60	50	85
126B	1,360	49' x 30'	16'5"	128	60	50	90
126C	1,300	48' x 29'	16'5"	118	60	50	85
126A-C	3,960	49' x 88'	16'5"	364	180	150	260
127A	1,300	48' x 29'	16'5"	118	60	50	85
127B	1,360	49' x 30'	16'5"	128	60	50	90
127C	1,300	49' x 29'	16'5"	118	60	50	85
127A-C	3,960	49' x 88'	16'5"	364	180	150	260
128A	1,360	51' x 29'	16'5"	118	60	50	90
128B	1,380	52' x 29'	16'5"	128	60	50	90
128AB	2,740	52' x 58'	16'5"	246	120	100	180
129A	2,180	38' x 60'	16'5"	220	121	110	145
129B	2,180	38' x 60'	16'5"	220	121	110	145
129AB	4,360	76' x 60'	16'5"	440	242	220	290
130	1,560	54' x 30'	16'5"	156	82	50	105
131A	1,500	54' x 29'	16'5"	144	82	50	100
131B	1,560	54' x 30'	16'5"	156	82	50	105
131C	1,500	54' x 29'	16'5"	144	82	50	100
131A-C	4,560	54' x 88'	16'5"	444	246	150	305
132A	1,500	54' x 29'	16'5"	144	82	50	100
132B	1,560	54' x 30'	16'5"	156	82	50	105
132C	1,500	54' x 29'	16'5"	144	82	50	100
132A-C	4,560	54' x 88'	16'5"	444	246	150	305
TOTAL	43,000						

PRE-FUNCTION
*SF Area is rounded.

30,000

Standard Set Classroom 3 chairs per 6' Table
4 chairs per 8' Table

ALL NUMBERS REFLECT
ATTENDEE CAPACITY

BALLROOM SPACE

ROOM - STREET LEVEL	AREA (SF*)	DIMENSIONS	CEILING HGT.	THEATER	CLASSROOM	BANQUET	RECEPTION
120A-D	45,600	276' x 165'	29'	4,200	2,750	2,470	4,100
120A	15,000	91' x 165'	29'	1,280	800	650	1,350
**120AB, 120CD	22,800	139' x 165'	29'	1,900	1,200	1,100	2,052
120B	7,800	47' x 165'	29'	740	450	380	702
**120BC	15,600	94' x 165'	29'	1,355	800	650	1,404
120D	15,000	91' x 165'	29'	1,280	800	650	1,350
TOTAL	45,600						

BALLROOM PRE-FUNCTION 25,000

ALL NUMBERS REFLECT ATTENDEE CAPACITY

STREET LEVEL OUTDOOR PATIOS #1 = 850, #2 = 900, #3 = 720, #4 = 720

*SF Area rounded.
**Room 120 C cannot be used alone. All specs for 120AB and 120CD are identical.

The Street Level features our 45,600 square-foot North Ballroom with 25,000 square feet of pre-function space, and a porte cochere pull-in for guest drop off. This exquisite ballroom includes a fully automated audiovisual system including dimmable lighting, sound system, and production balcony. The unique ceiling treatment is complemented by metallic fabric kites designed to replicate the desert sky with a rigging capacity of 2,500 pounds per point. The North Ballroom, the largest ballroom in the State of Arizona, boasts high-end wood finishes inset with decorative lighting to create an elegant setting for any occasion.

This level also features 28 meeting rooms with more than 43,000 square feet of meeting space and includes four unique outdoor patios, each offering between 720 to 900 square feet of useable space for receptions to provide the perfect outdoor dining experience in the beautiful Arizona weather.

The *metroMarché* food court offers four themed eateries as well as yogurt and coffee bars, providing a variety of dining options for guests. A relaxing gathering place for breaks, the *metroMarché* also offers free WiFi and flat screen TVs.

The convention center's satellite ticket office, information desk and The UPS Store Business Center are also located on the Street Level. The street level location offers convenient back-of-house load-in access.



North Ballroom Pre-function



North Ballroom Banquet



For more information, or to reserve event space
please call: 800.282.4842 or visit: phoenixconventioncenter.com

100 North Third Street | Phoenix, AZ 85004
602.262.6225 | TTY 602.495.5048



PHOENIX CONVENTION CENTER

North Building | Meeting Rooms | 200 Level



Meeting Room



Pre-function Area

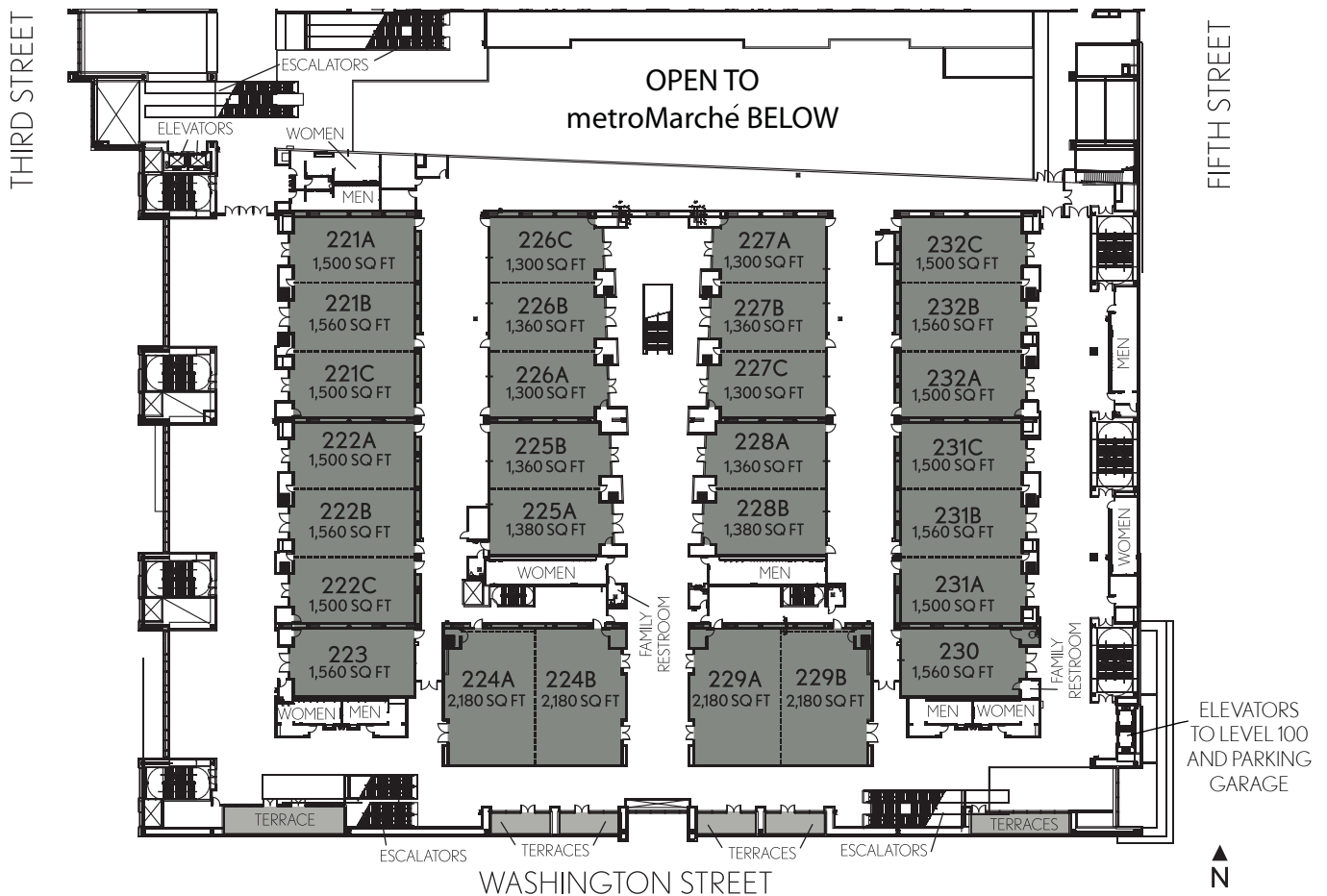

PHOENIX CONVENTION CENTER

North Building | Meeting Rooms | 200 Level

MEETING SPACE

ROOM - STREET LEVEL	AREA (SF*)	DIMENSIONS	CEILING HGT.	THEATER	CLASSROOM	BANQUET	RECEPTION
221A	1,500	54' x 29'	16'5"	144	82	50	100
221B	1,560	54' x 30'	16'5"	156	82	50	105
221C	1,500	54' x 29'	16'5"	144	82	50	100
221A-C	4,560	54' x 88'	16'5"	444	246	150	305
222A	1,500	54' x 29'	16'5"	144	82	50	100
222B	1,560	54' x 30'	16'5"	156	82	50	105
222C	1,500	54' x 29'	16'5"	144	82	50	100
222A-C	4,560	54' x 88'	16'5"	444	246	150	305
223	1,560	54' x 30'	16'5"	156	82	50	105
224A	2,180	38' x 60'	16'5"	220	121	110	145
224B	2,180	38' x 60'	16'5"	220	121	110	145
224AB	4,360	76' x 60'	16'5"	440	242	220	290
225A	1,380	52' x 29'	16'5"	128	60	50	90
225B	1,360	51' x 29'	16'5"	118	60	50	90
225AB	2,740	52' x 58'	16'5"	246	120	100	180
226A	1,300	49' x 29'	16'5"	118	60	50	85
226B	1,360	49' x 30'	16'5"	128	60	50	90
226C	1,300	48' x 29'	16'5"	118	60	50	85
226A-C	3,960	49' x 88'	16'5"	364	180	150	260
227A	1,300	48' x 29'	16'5"	118	60	50	85
227B	1,360	49' x 30'	16'5"	128	60	50	90
227C	1,300	49' x 29'	16'5"	118	60	50	85
227A-C	3,960	49' x 88'	16'5"	364	180	150	260
228A	1,360	51' x 29'	16'5"	118	60	50	90
228B	1,380	52' x 29'	16'5"	128	60	50	90
228AB	2,740	52' x 58'	16'5"	246	120	100	180
229A	2,180	38' x 60'	16'5"	220	121	110	145
229B	2,180	38' x 60'	16'5"	220	121	110	145
229AB	4,360	76' x 60'	16'5"	440	242	220	290
230	1,560	54' x 30'	16'5"	156	82	50	105
231A	1,500	54' x 29'	16'5"	144	82	50	100
231B	1,560	54' x 30'	16'5"	156	82	50	105
231C	1,500	54' x 29'	16'5"	144	82	50	100
231A-C	4,560	54' x 88'	16'5"	444	246	150	305
232A	1,500	54' x 29'	16'5"	144	82	50	100
232B	1,560	54' x 30'	16'5"	156	82	50	105
232C	1,500	54' x 29'	16'5"	144	82	50	100
232A-C	4,560	54' x 88'	16'5"	444	246	150	305
TOTAL	43,000						
PRE-FUNCTION	31,800	Standard Set Classroom: 3 chairs per 6' table 4 chairs per 8' table		ALL NUMBERS REFLECT ATTENDEE CAPACITY			
*SF Area rounded.							

The Second Level features 28 meeting rooms with more than 43,000 square feet of versatile break-out space. Rooms can easily be divided or expanded to meet the need of any event and are linked by a back-of-the-house corridor to ensure uninterrupted service. This level offers 31,800 square feet of comfortable pre-function space adjacent to the meeting rooms and six outdoor terraces to break from meeting routine and enjoy the beautiful Arizona climate.



For more information, or to reserve event space
Please call: 800.282.4842 or visit: phoenixconventioncenter.com

100 North Third Street | Phoenix, AZ 85004
602.262.6225 | TTY 602.495.5048



FAMILY OF VENUES

Phoenix Convention Center | Executive Conference Center | Symphony Hall | Orpheum Theatre

4/2012

PHOENIX CONVENTION CENTER

North Building | Exhibition Hall | 300 Level

MONROE STREET

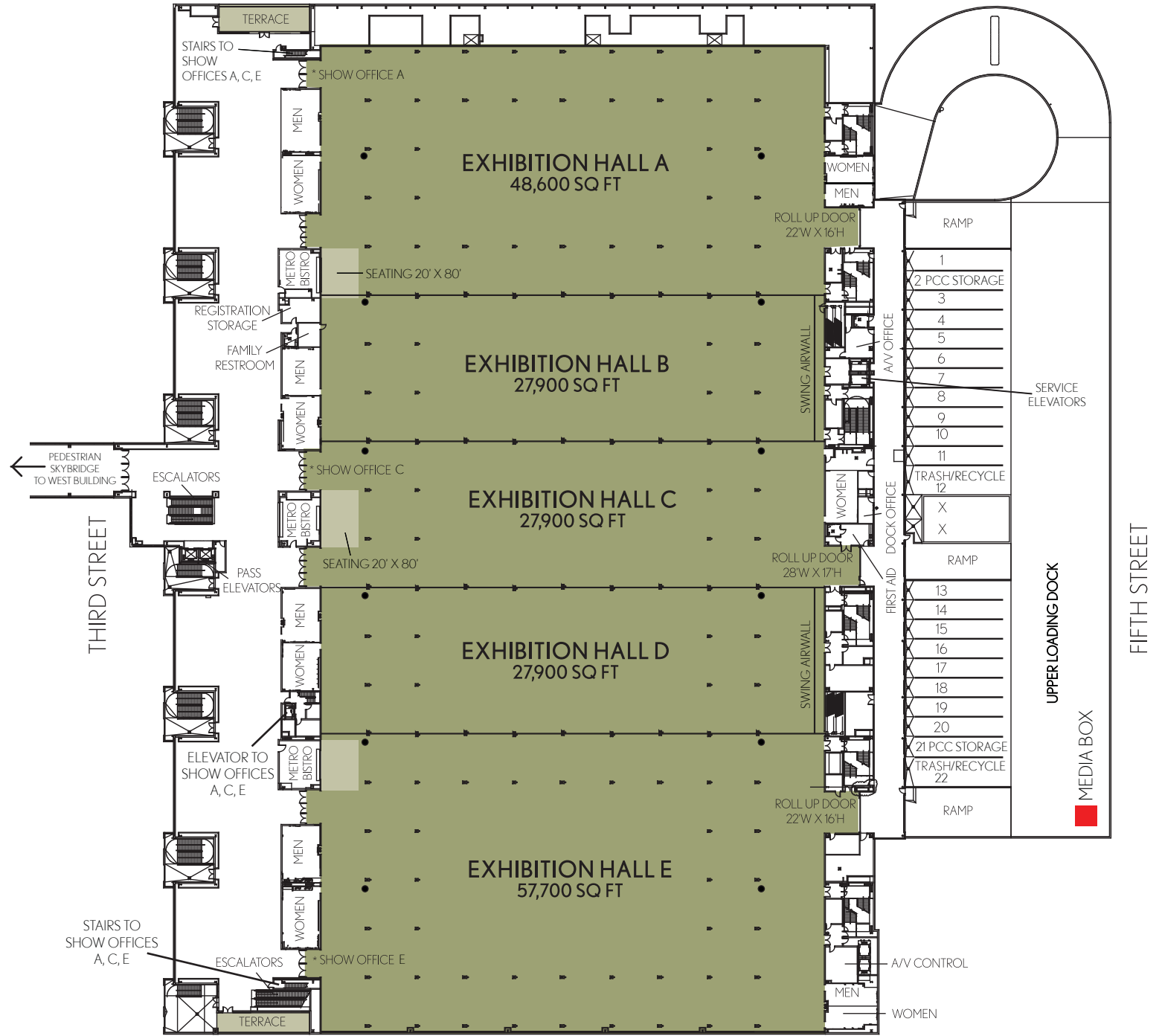

* Show Office overlooks floor.

WASHINGTON STREET



PHOENIX CONVENTION CENTER

North Building | Exhibition Hall | 300 Level

EXHIBITION SPACE

HALLS - UPPER LEVEL	AREA(SF*)	DIMENSIONS	CEILING HGT.	THEATER	CLASSROOM	BANQUET	10' X 10' EXHIBITS
HALL A	48,600	153' x 310'	35'	3,960	2,672	1,890	278
HALL B+	27,900	90' x 310'	35'	2,510	1,725	1,390	167
HALL C++	27,900	90' x 310'	35'	2,510	1,725	1,390	165
HALL D+	27,900	90' x 310'	35'	2,510	1,725	1,390	168
HALL E	57,000	183' x 310'	35'	4,940	3,325	2,410	331
TOTAL	190,000						

PRE-FUNCTION

33,000

ALL NUMBERS REFLECT ATTENDEE CAPACITY

*SF Area rounded.

+Halls B and D cannot be booked independently.

++Suggest Hall C cannot be utilized independently.

Standard Set Classroom 3 chairs per 6' Table

4 chairs per 8' Table

The Upper Level Exhibition Hall offers 190,000 square feet of virtually column-free exhibit space with a 300 pounds/square foot floor weight capacity and rigging capacity of 2,500 pounds per point. Columns are located on the east and west perimeters of the hall allowing for a clear span of 237 feet through the center of the room. The Exhibition Hall's concrete floors are scored on a 10' x 10' grid and a 30' x 30' utility grid to expedite the move-in process. Three permanent Metro Bistros provide convenient dining options for guests on this level.

Accessible by a semi-truck ramp with a clearance height of 16', the 300 Level loading dock has 18 truck bays, three ramps and three convenient roll-up doors (22'w x 16'h, 22'w x 16'h and 18'w x 17'h). The level also features a dedicated dock office and three show offices that overlook the show floors.

33,000 square feet of expansive pre-function space is located just outside the 300 Level Exhibition Hall, providing a perfect location for registration and/or various event functions. An enclosed pedestrian bridge connects the West and North buildings.



Banquet Rounds



Skybridge connecting
North & West Buildings



Tradeshow



For more information, or to reserve event space
please call: 800.282.4842 or visit: phoenixconventioncenter.com

100 North Third Street | Phoenix, AZ 85004
602.262.6225 | TTY 602.495.5048



FAMILY OF VENUES

Phoenix Convention Center | Executive Conference Center | Symphony Hall | Orpheum Theatre

4/2012

PHOENIX CONVENTION CENTER

North Building | Exhibition Hall | Lower Level

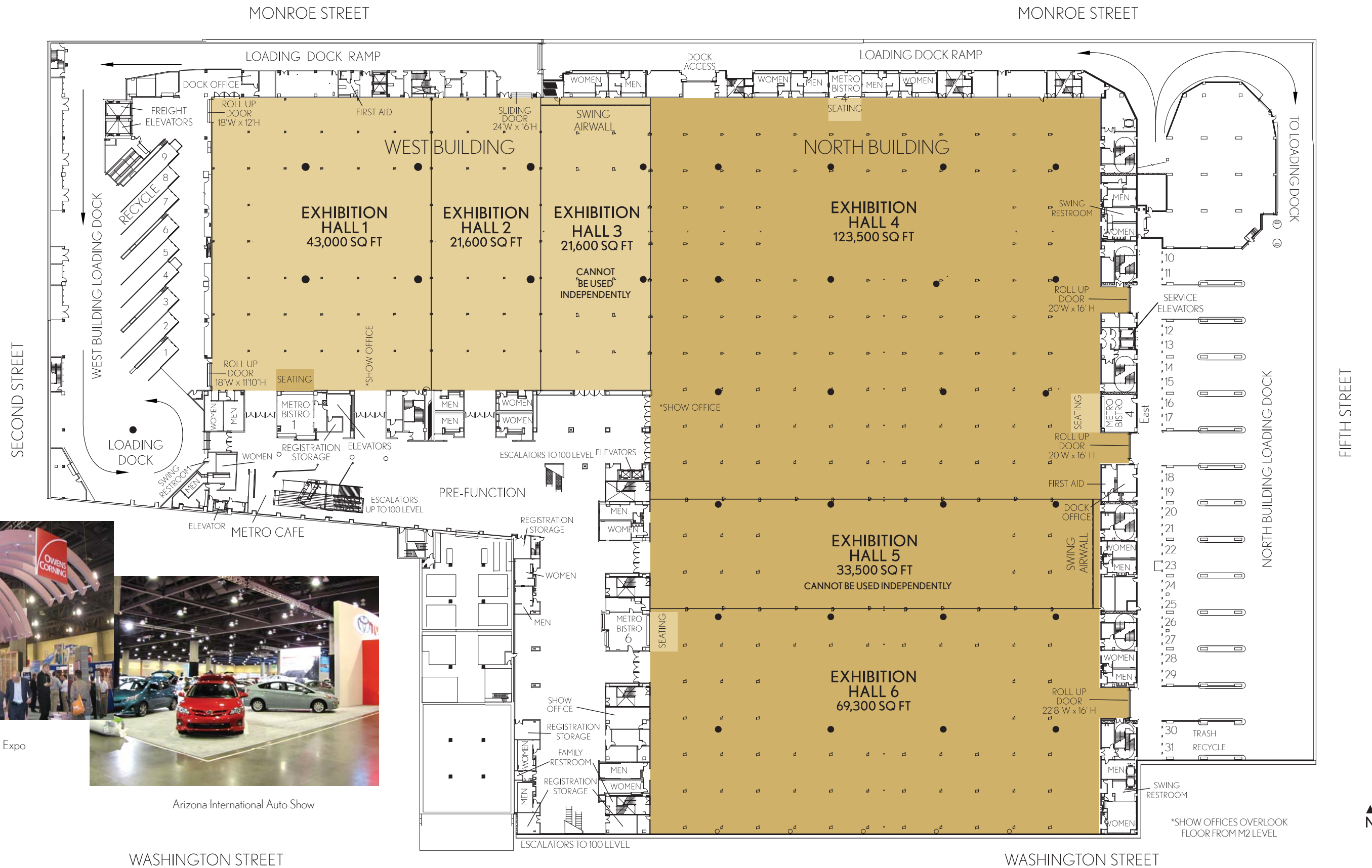

GreenBuild Expo



Arizona International Auto Show

North Building | Exhibition Hall | Lower Level

The Phoenix Convention Center ranks among the top 25 largest convention centers in the U.S. Offering nearly 900,000 square feet of meeting space with 13 exhibit halls, 99 meeting rooms and three ballrooms. The Phoenix Convention Center’s state-of-the-art design captures and exhibits the unique geographical features of Arizona. The facility’s accessible layout features a stacked floor plan to accommodate multiple groups simultaneously.

The Phoenix Convention Center, a LEED-silver certified green building, has received recognition for its sustainability efforts. The center features many green amenities throughout its facility and incorporates sustainable initiatives into daily operations. As an active participant in the Green Meetings Market, the Phoenix Convention Center has hosted the U.S. Greenbuild Conference and several other green meetings and events.

Artwork has been a critical component of the Phoenix Convention Center since it originally opened in 1972. Building upon a commitment to the arts, the covention center participates in the city of Phoenix Office of Arts and Culture Public Art Program. As part of the Phoenix Convention Center expansion, a \$3.2 million public art project commissioned 10 artists to create new artwork for the West and North Buildings.

EXHIBITION SPACE							10 X 10
HALLS - LOWER LEVEL	AREA (SF*)	DIMENSIONS	CEILING HGT.	THEATER	CLASSROOM	BANQUET	EXHIBITS
HALL 1	43,000	180' X 240'	32'	Upon request customized seating configurations may be provided			253
HALL 2	21,600	90' X 240'	32'				125
HALL 3**	21,600	90' X 240'	32'				130
HALL 4	123,500	370' X 330'	32'				687
HALL 5**	33,500	370' X 90'	32'				202
HALL 6	69,300	370' X 185'	32'				399
TOTAL	312,500						
TOTAL PRE-FUNCTION SPACE - 40,000							**Halls 3 and 5 cannot be booked independently
*SF Area rounded							



WWE Fan Axxess



Arizona Beach - Public Artwork - North Building Lobby



GreenBuild Expo



COMICON



MLB FanFest

The Lower Level Exhibition Hall offers 312,500 square feet of contiguous exhibit space and connects the North and West Buildings under Third Street. The halls are scored on a 10' x 10' grid and a 30' x 30' utility grid to expedite the move-in process. The Lower Level Exhibition Hall has a 350 pounds/square foot floor weight capacity and rigging capacity of 2,500 pounds/point. This level includes three dedicated show offices, two overlook the show floor and two are in the adjacent pre-function area.

The Lower Level features two convenient access points for move-in. The North Building loading dock features 20 truck bays, three ramps and three convenient roll-up doors (two at 20' w x 16' h and one at 22'8" w x 16' h). The West Building loading dock provides eight truck bays, two roll-up doors (18' w x 12' h and 18' w x 11'10" h) and a semi-truck turnaround. Trucks with a wheelbase of 73' or less can access the Exhibition Hall floor on this level via a sliding door (24' w x 16' h).

40,000 square feet of spacious pre-function space, located just outside the Lower Level Exhibition Hall, is available for registration and other event functions. Convenient dining options for guests include four Metro Bistros, two of which are double-sided and are accessible from the pre-function area and the Lower Level Exhibition Hall.



Lighting Crystals - North Building



For more information, or to reserve event space please call: 800.282.4842 or visit: phoenixconventioncenter.com

100 North Third Street | Phoenix, AZ 85004
602.262.6225 | TTY 602.495.5048

